

The Main Hotel

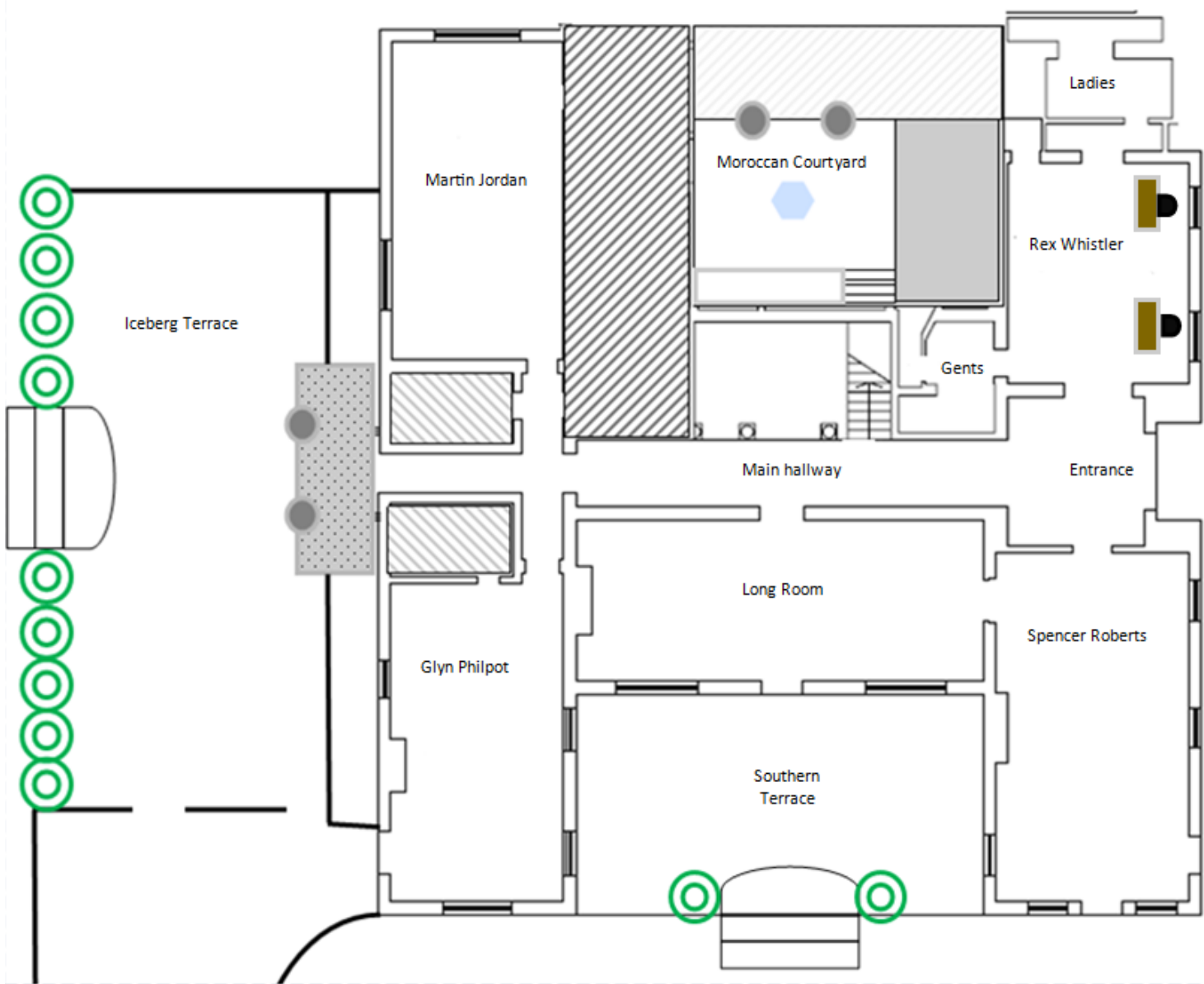

The Long Room

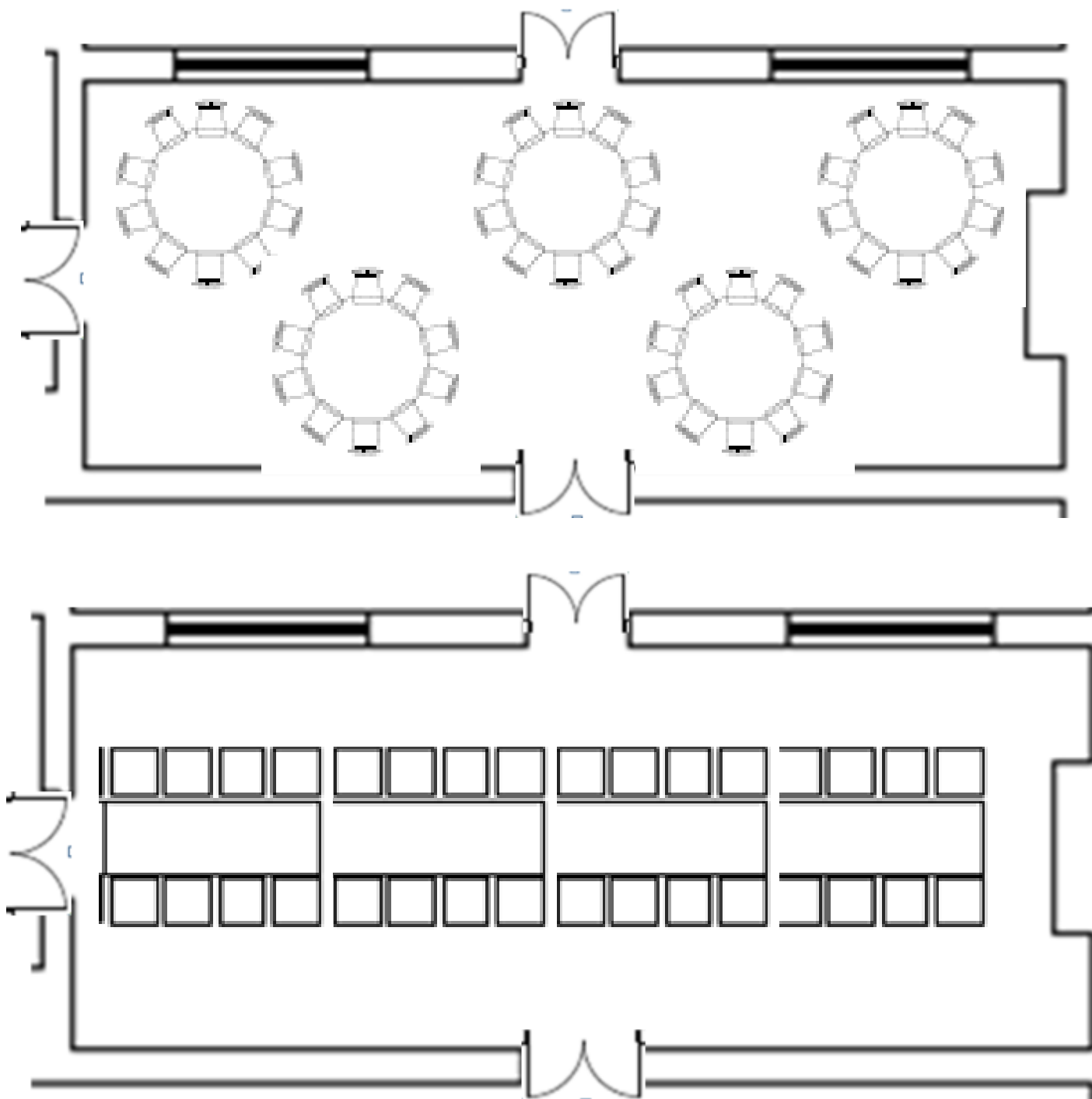

Maximum of 5 round tables, seating 10 guests at each table
Maximum 32 guests banquet style

Please match this plan to your menu choice spreadsheet by listing guests on the spreadsheet as:
1st guest listed- seated at the 'X'
Then listing guests moving clockwise around the table.

The Spencer Roberts Room

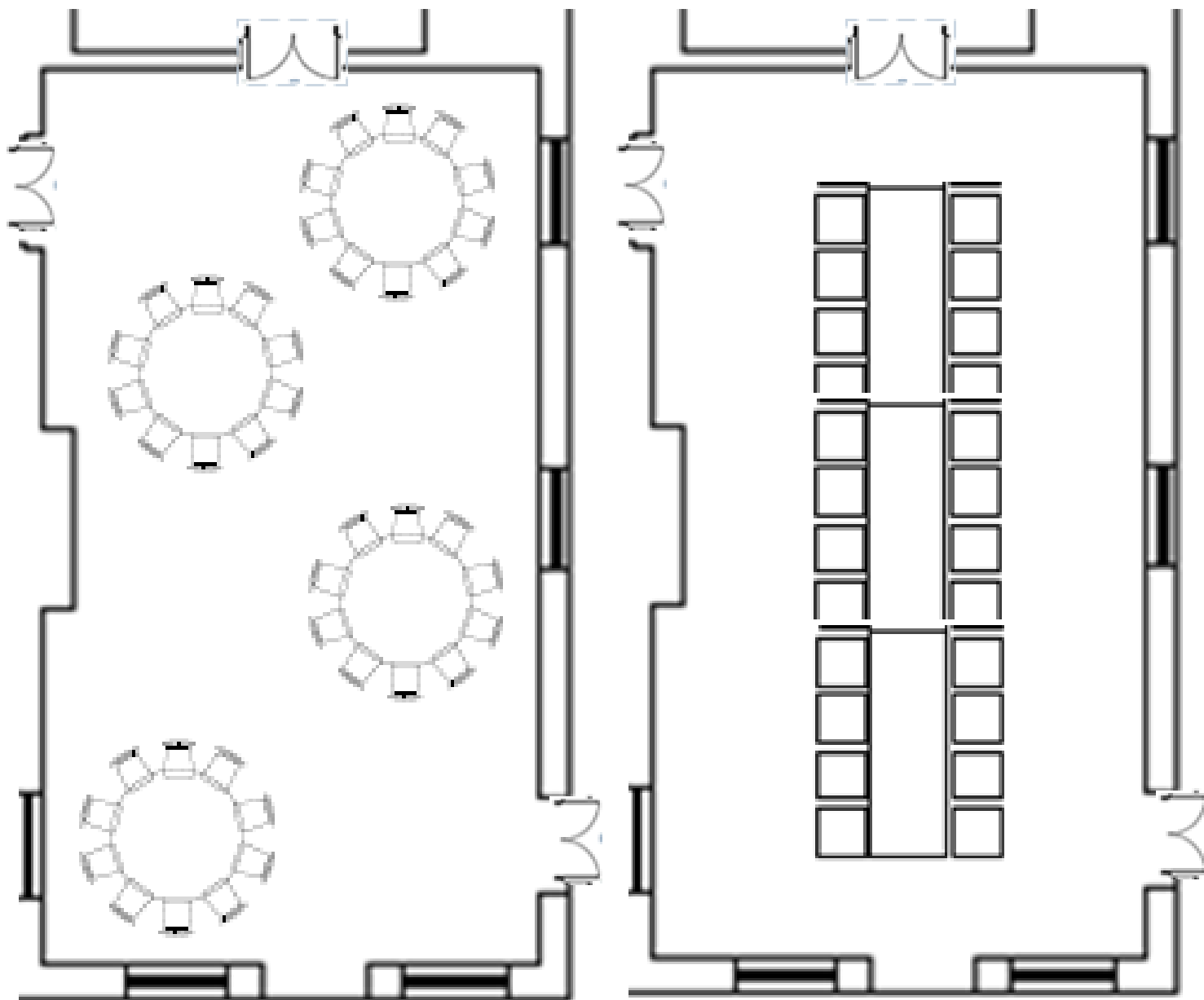

Maximum of 4 round tables, seating 10 guests at each table
Maximum 24 guests banquet style

Please match this plan to your menu choice spreadsheet by listing guests on the spreadsheet as:
1st guest listed- seated at the 'X'
Then listing guests moving clockwise around the table.

The Martin Jordan Room

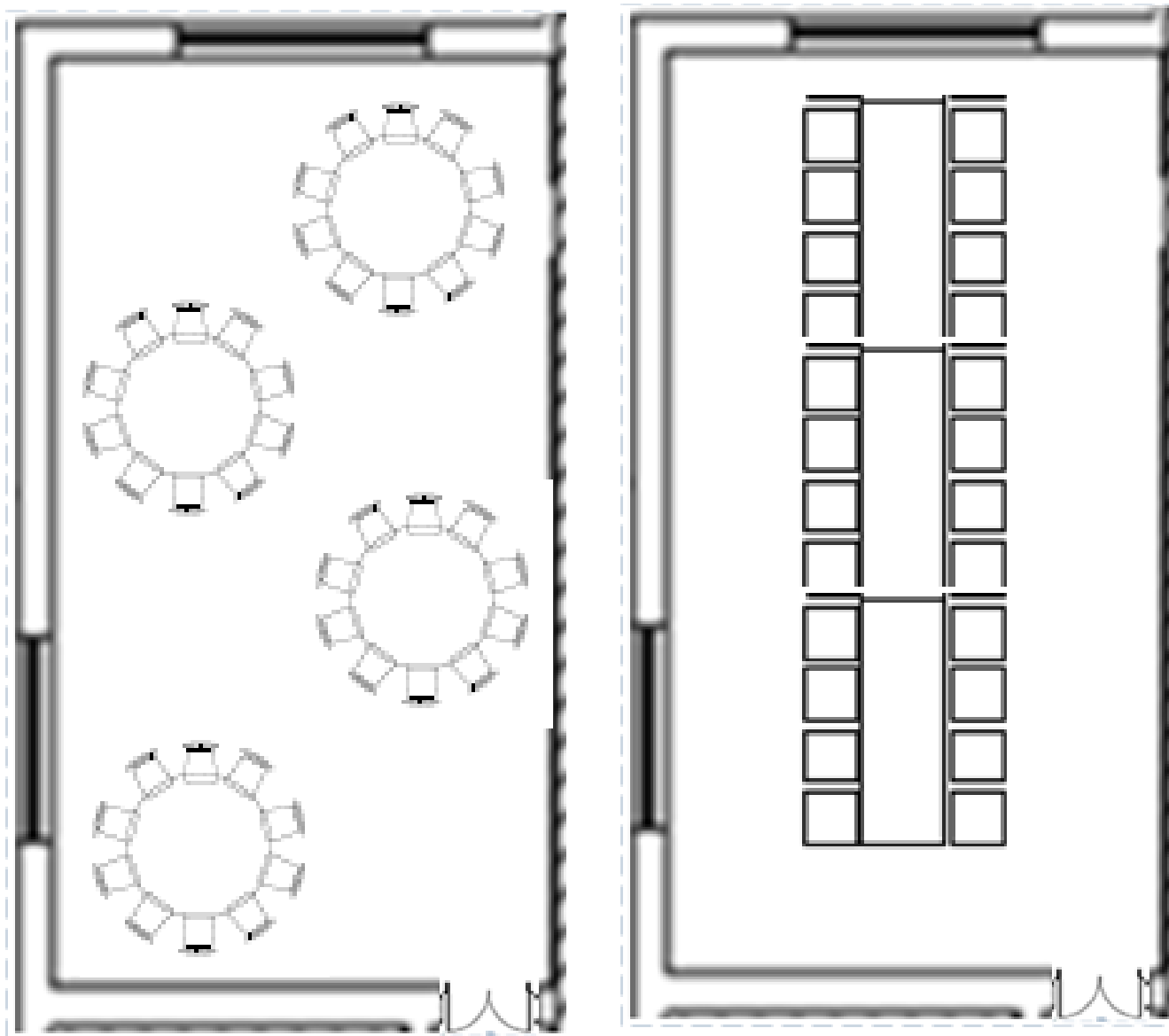

Maximum of 4 round tables, seating 10 guests at each table
Maximum 24 guests banquet style

Please match this plan to your menu choice spreadsheet by listing guests on the spreadsheet as:
1st guest listed- seated at the 'X'
Then listing guests moving clockwise around the table.

Garden Room example—Round tables

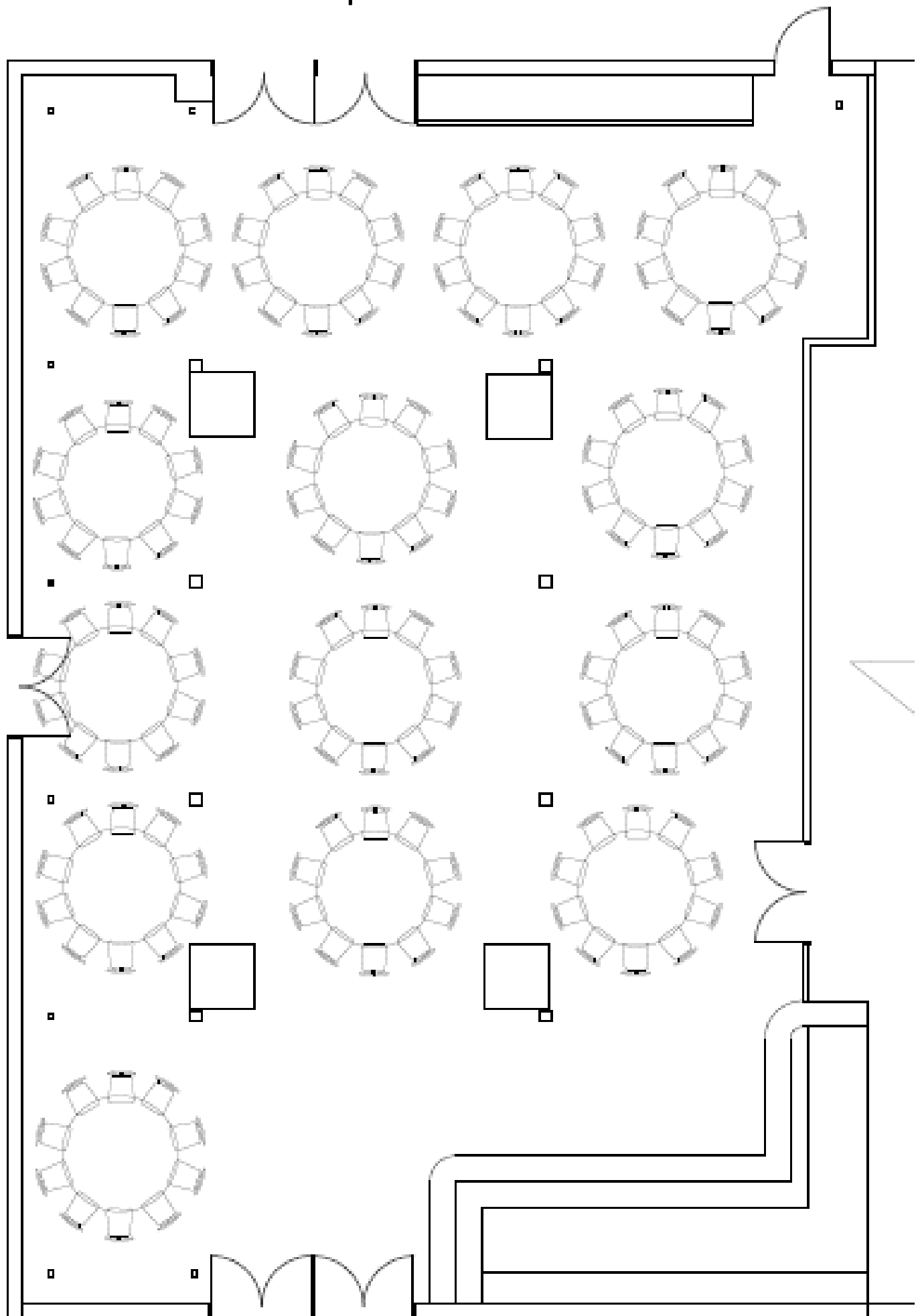

Garden Room example—Including top table

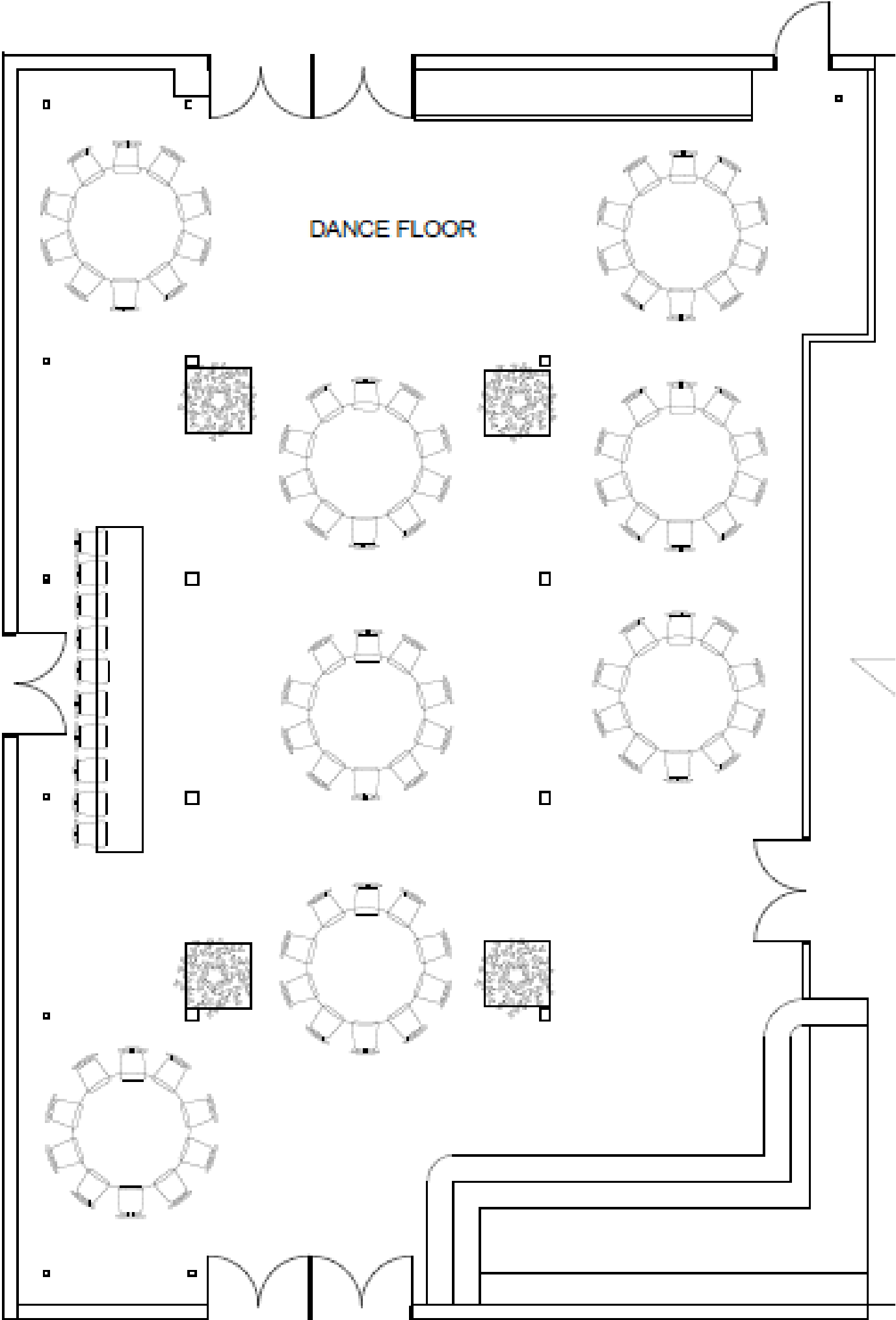

Garden Room example—Trestle tables

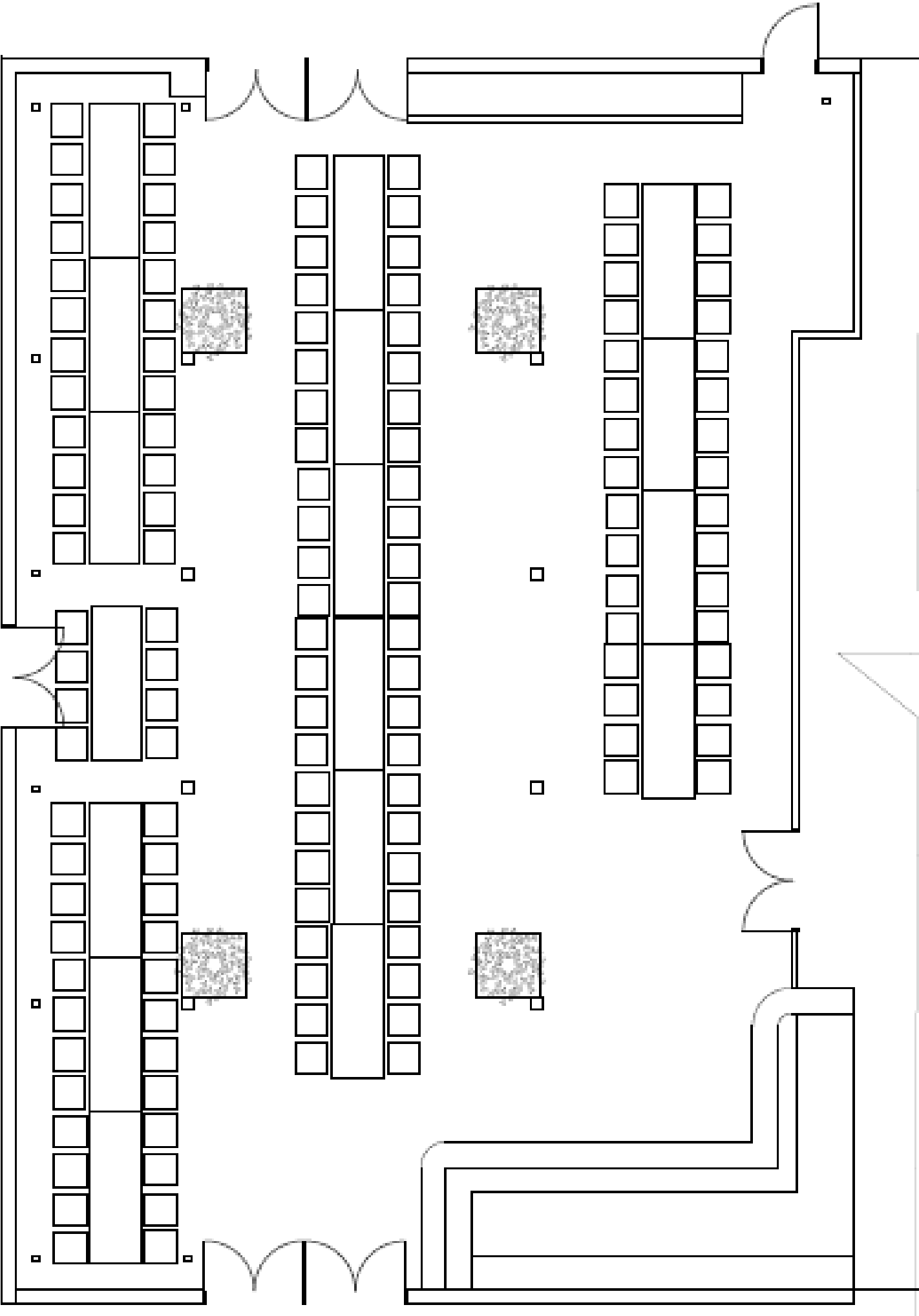

Your Table Plan

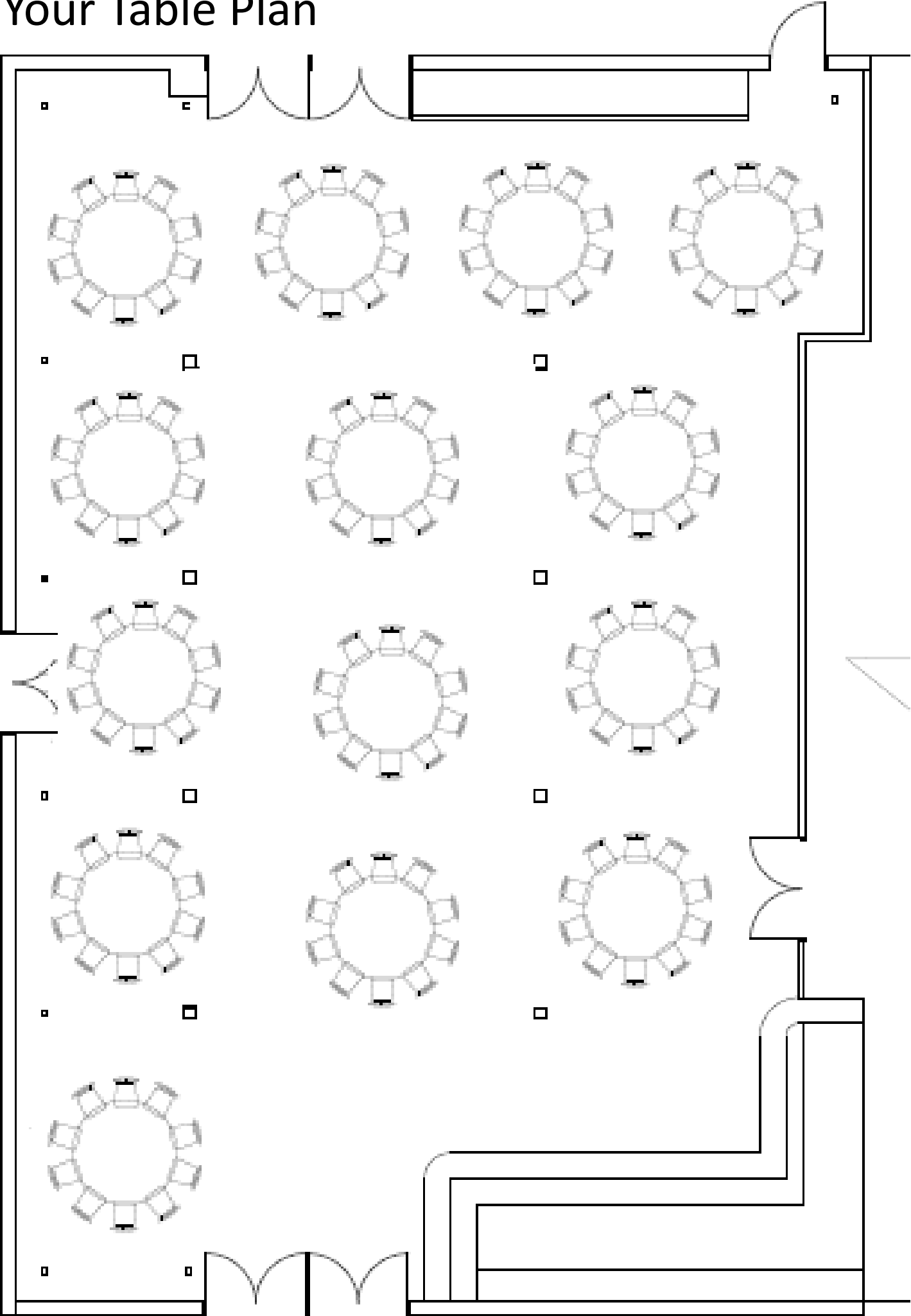

Your Table Plan

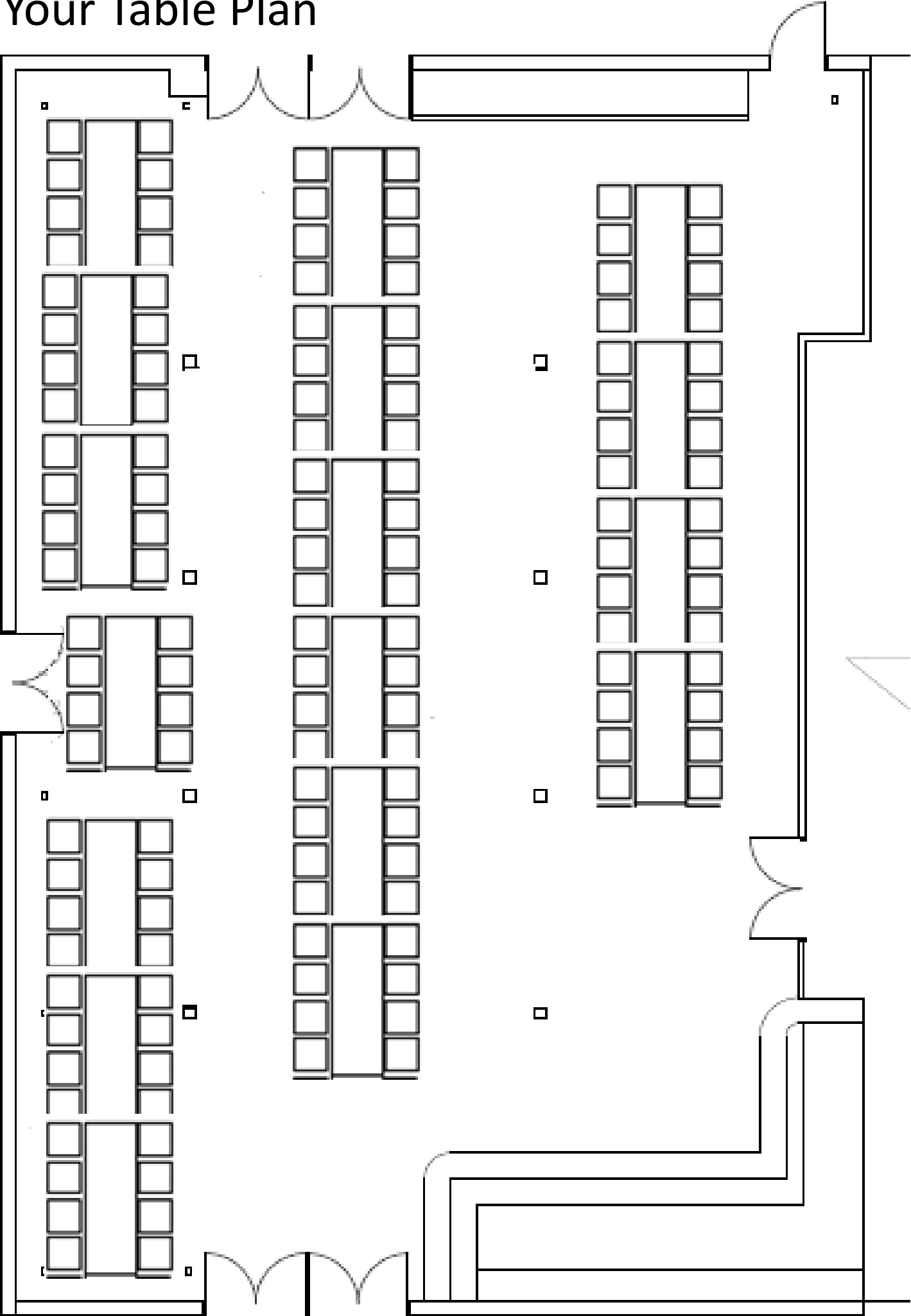

Additional tables

Please copy and paste onto your table plan.

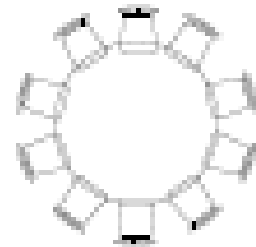
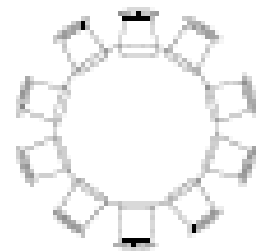
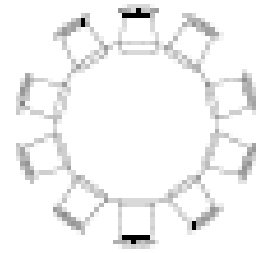
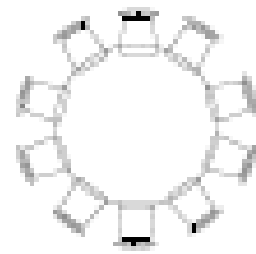
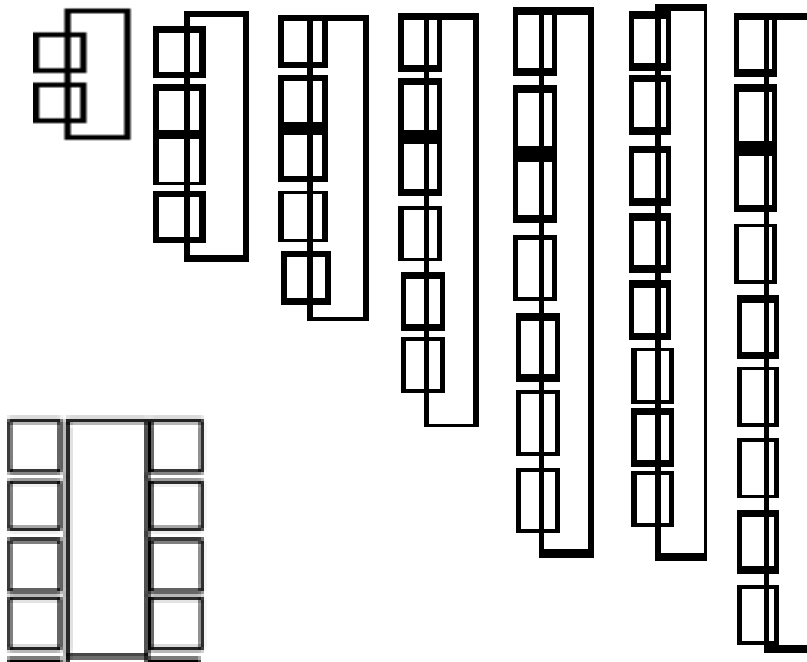

Guide

We request a minimum of 6 tables in the Garden Room as to not look too 'empty' and a maximum capacity of 14 round tables

We recommend a minimum of 7 guests per round table, with a maximum of 12 (however please avoid if possible to ensure comfort for your guests)

Please add/remove tables as needed for your plan and return to the team so that we can check we can accommodate your suggested plan.

Please see above additional tables for you to add to your suggested table plan
Please do not amend the sizes as they have been configured to reflect the size of the room plan.